

PLOT SCALE: 24000.0000' / ft. USER: wosthoff
9/26/2024 4:32:47 PM MODEL: TXDOT Design
pw://ea-pw.bentley.com/leap-pw-01/Documents/21630 TXDOT 88-9DP5025/4-Design/Plan Set/502-TCP/CR508-TC-P1.dgn
REV DATE: \$SAVED\$
CSJ: 0923-23-032

CR 508

DETOUR

↑

①

CR 508

DETOUR

←

②

CR 508

DETOUR

→

③

CR 508

END

DETOUR

④

←

DETOUR

ROAD CLOSED TO THRU TRAFFIC

⑤

DETOUR

→

ROAD CLOSED TO THRU TRAFFIC

⑥

W16-8P
30"X18"

M4-9S
30"X24"

W16-8P
30"X18"

M4-9L
30"X24"

W16-8P
30"X18"

M4-9R
30"X24"

W16-8P
30"X18"

M4-8
24"X18"

M4-10L
48"X18"

R11-4
60"X30"

M4-10R
48"X18"

R11-4
60"X30"

ROAD CLOSED AHEAD

⑦

ROAD CLOSED 1000 FT

⑧

ROAD CLOSED 500 FT

⑨

END ROAD WORK

⑩

OBEY WARNING SIGNS STATE LAW

⑪

CW20-3D
36"X36"

CW20-3B
36"X36"

CW20-3C
36"X36"

G20-2a
36"X18"

R20-3
48"X42"

TRAFFIC CONTROL SEQUENCE:

THE CONTRACTOR SHALL BE REQUIRED TO SUBMIT A DETAILED SCHEDULE OF WORK TO THE AREA ENGINEER PRIOR TO THE BEGINNING OF CONSTRUCTION, WHICH GENERALLY CONFORMS TO THE FOLLOWING SEQUENCE:

1. INSTALL PROJECT LIMIT SIGNING AND BARRICADES AND SW3P PRIOR TO BEGINNING ANY OTHER WORK.
2. ALL ROAD CLOSURE SIGNING SHALL BE IN PLACE PRIOR TO ANY ACTIVITIES WHICH WILL PROHIBIT THROUGH TRAFFIC AND SHALL BE PLACED MORE THAN 24 HOURS PRIOR TO SUCH ACTIVITY.
3. COMPLETE THE CONSTRUCTION OF THE BRIDGE AND APPROACHES ACCORDING TO THE PLANS AND SPECIFICATIONS AND AS DIRECTED BY THE ENGINEER.
4. THE ROADWAY SHALL BE OPEN TO THROUGH TRAFFIC AS SOON AS DETERMINED PRACTICAL BY THE ENGINEER.
5. COMPLETE ALL OTHER WORK AS DIRECTED BY THE ENGINEER.

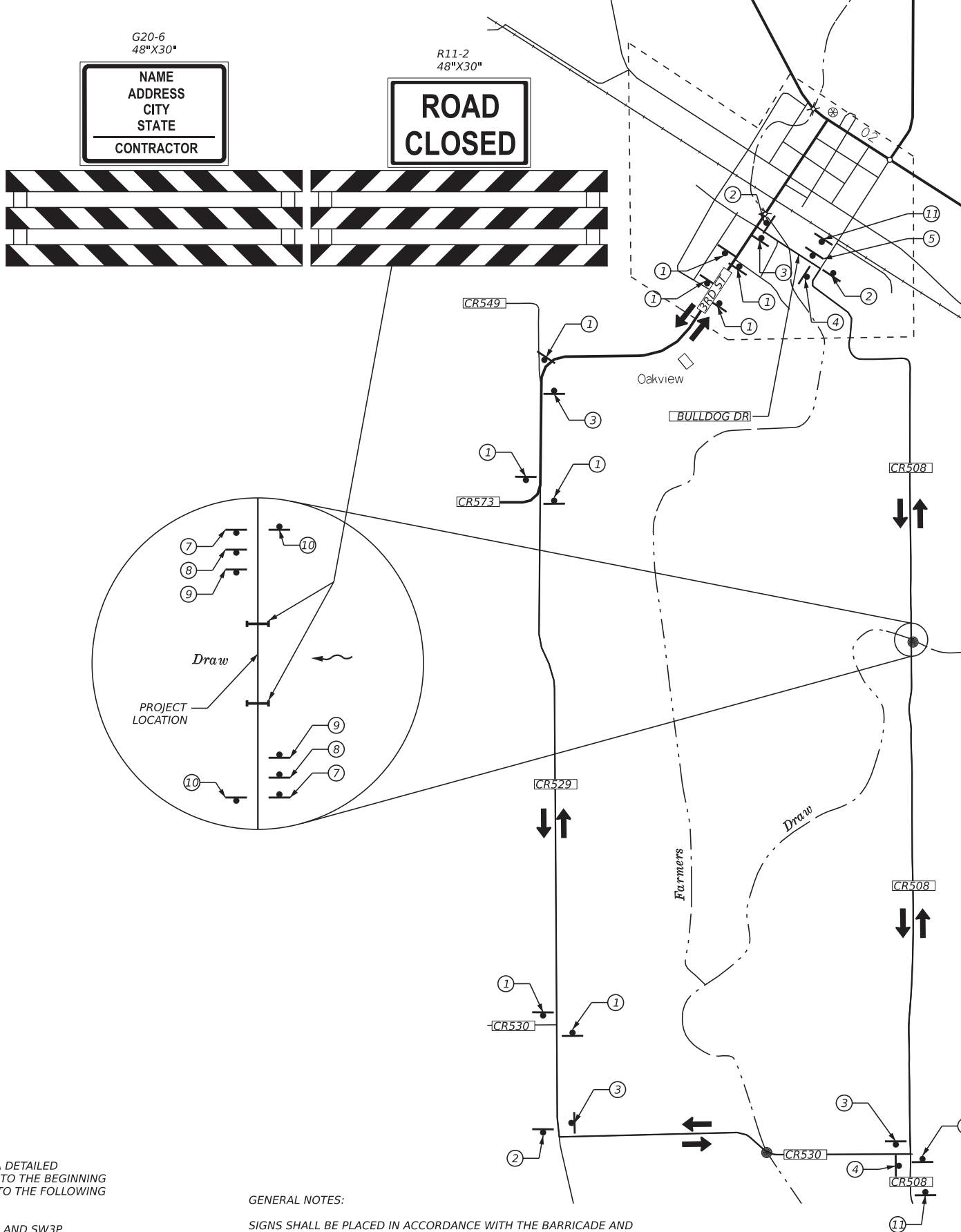

GENERAL NOTES:

SIGNS SHALL BE PLACED IN ACCORDANCE WITH THE BARRICADE AND CONSTRUCTION STANDARDS OR AS DIRECTED BY THE ENGINEER.

OTHER SIGNS AS DETAILED IN THE BARRICADE AND CONSTRUCTION STANDARDS AND IN THE TMUTCD MAY BE USED AS REQUIRED BY THE ENGINEER IN ORDER TO PROVIDE FOR THE SAFE PASSAGE OF TRAFFIC THROUGH THE PROJECT. PAYMENT FOR ALL SUCH SIGNS, BARRICADES OR TRAFFIC CONTROL DEVICES SHALL BE CONSIDERED SUBSIDIARY TO ITEM 502 "BARRICADES, SIGNS AND TRAFFIC HANDLING".

PROVIDE ACCESS TO AND FROM DRIVEWAYS AND ALL ADJACENT PROPERTY AT ALL TIMES.

LEGEND	
	SIGN
	TY III BARRICADES

DETOUR LENGTH: 7.0 MILES
ADT: <400

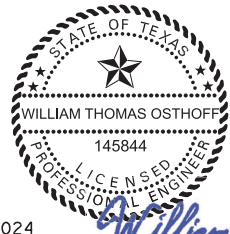

9/26/2024

NO.	DATE	REVISION	APPROV.
13501 KATY FREEWAY SUITE 3425 HOUSTON, TEXAS 77079 (832) 494-3800			
FIRM REGISTRATION No. F-10161			
Texas Department of Transportation Bryan District			
© 2024			
CR 508 AT DRAW			
TRAFFIC CONTROL PLAN			
SHEET 1 OF 1			
FED. RD. DIV. NO.	PROJECT NUMBER	HIGHWAY NUMBER	
6	SEE TITLE SHEET	CR 508	
STATE	DISTRICT	COUNTY	
TEXAS	BWD	MILLS	
CONTROL	SECTION	JOB	SHEET NO.
0923	23	032	9